

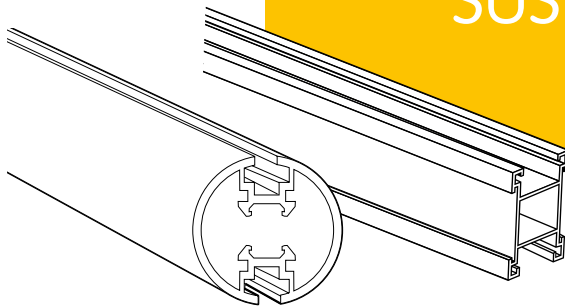

SUSPENSION SYSTEMS



SUSPENSION SYSTEMS

POSTER RAILS

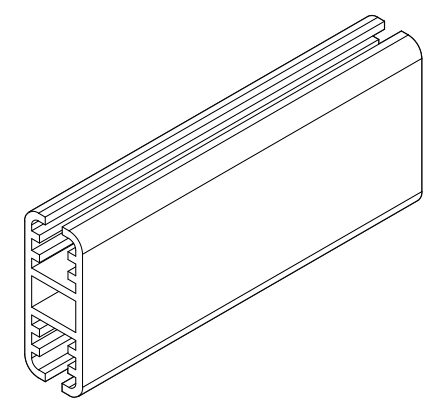

POSTER RAIL AMBIENTE
 Alu-anodized aluminium profile (42 x 17 mm), can be easily bended e.g. for use as full or semi circle or similar. As full circle available in radiuses:
 R 800 mm | 50920-91/R0800
 R 1250 mm | 50920-91/R1250

Poster rail Ambiente:
 1000 mm | 50920-91/1000

Other lengths upon request.

Please order cable suspensions separately.

Of the accessories series 500 there can be used: Rail ring to be directly turned into poster rails Art.-No. 25730-xx (only colored), Hanging ring Art.-No. 25710-03 (grey) and suspension ring Art.-No. 25700-xx (colored and clear).

We are happy to create your individual offer.

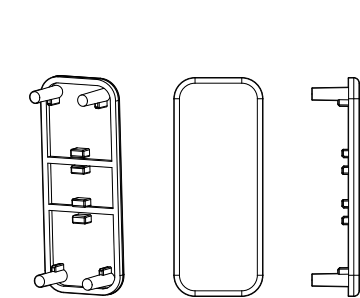
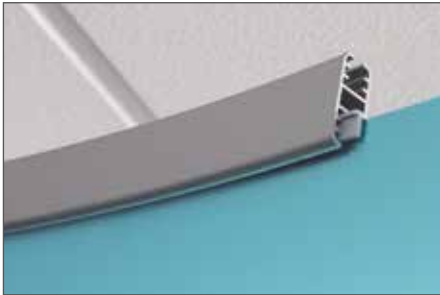

END CAP RAIL AMBIENTE
 Suits poster rail Ambiente for a neat rail end, grey.
 25686-03



FOIL GRIP
 Clip for poster rail Ambiente with profile for a secure hold of foils with material thickness of 0,4 - 0,8 mm.
 Foil Grip SG, grey | 25780-03
 Foil Grip XT, black | 25785-10



CABLE SUSPENSION WITH PLATE FOR AMBIENTE RING
 Suitable to suspend our poster rail Ambiente as ring. Adjustable wire cable Ø 1,5 mm with slipknot, zinedc plate for a quick and easy, sideways insert into the rail profile. Further lengths and cable suspensions for poster rail Ambiente (straight) available upon request.
 2000 mm | 25699-00/2000



POSTER RAILS

Energize your advertising with our selection of OEK poster rails! Various types of suspension rails made of plastic and aluminium with an extensive set of accessories allow for the perfect placement of showcard frames, price displays, profile frames and much more, regardless of the application.

Remark:

For fixing the aluminium poster rails you can also use the following elements:

- Poster rail I: → **accessories showcard frames (series 100)**
- Poster rails II and III: → **accessories showcard frames (series 500)**

Colors:

The aluminium poster rails are also available in special colors (coated similar to RAL colors). Please contact us for more details or a quote.

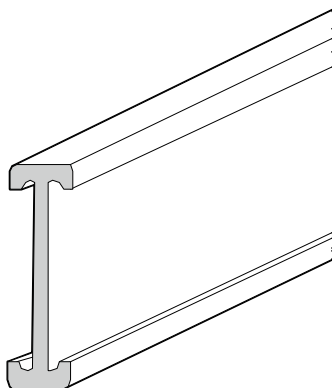

POSTER RAIL I

Anodized aluminium, profile 45 x 10 mm, with insert for promotional strips with 39 mm height. Standard lengths 200 and 300 cm. Special colors are available upon request.

For suitable elements to suspend rail and frames, please see chapter accessories showcard frames (series 100). Available upon request.

15401-90/xxxx

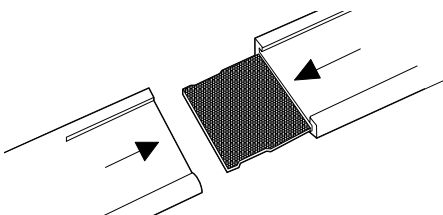

CONNECTOR FOR POSTER RAIL I

To connect single poster rails I, zinc coated metal.

25601-00

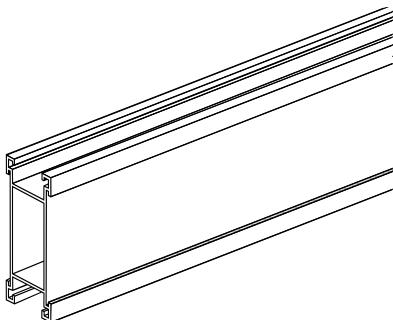

POSTER RAIL II

Anodized aluminium, profile 20 x 40 mm, insert for promotional strips with 32 mm height, standard lengths 100, 200 and 300 cm. Special colors are available upon request.

15402-90/xxxx



SUSPENSION SYSTEMS

POSTER RAILS



POSTER RAIL III

Anodized aluminium, profile 20 x 20 mm, standard lengths 100, 200 and 300 cm. Special colors are available upon request.

15403-90/xxxx



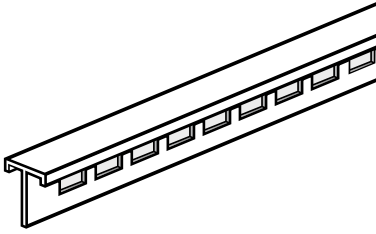

GRIP STRIP

For direct insert into poster rails II and III, allows for a quick and easy change of your information displays. Made of clear plastics, standard lengths 100 and 200 cm. PU: 10 pcs.

22570-xxxx





HANGER WITH BENDED SCREW HOOK

Hanger for poster rail II - consisting of zinced steel plate (50 x 14 x 3 mm with thread M4) and bended screw hook (zinced).

6-00379-0004



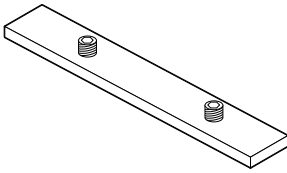

CONNECTOR

To connect two single rails, suits poster rails II and III, zinc coated metal with 2 stud screws.

With poster rail II we recommend to use two connectors.

25610-00

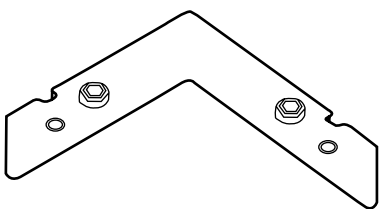

CORNER CONNECTOR 90°

Suits poster rails II and III, to connect two rails with mitred corners, zinc coated metal with 4 stud screws.

With poster rail II we recommend to use two connectors.

25620-00



T-CONNECTOR FOR ALU POSTER RAIL II AND III
For a stable and invisible T-connection of poster rails II and III, zinc coated metal. Set consisting of 2 T-connectors, 4 standard connectors and 8 screws.

25625-00

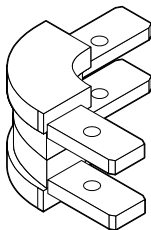

CORNER CONNECTOR, 2-PARTS
Suits poster rail II, to connect two rails without mitred corners in a 90° angle, 2-parts with screws, grey.

25650-03



END CAP II
Suits poster rail II, for a neat closing, grey.

25670-03

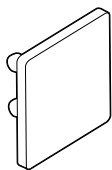

END CAP III
Suits poster rail III, for a neat closing, grey.

25680-03

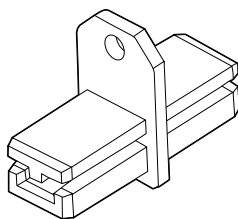

CONNECTOR (RAIL III) WITH RING
Suits poster rail III, to connect two rails while suspending them by the integrated ring, grey.

25630-03

SUSPENSION SYSTEMS

ACCESSORIES FOR POSTER RAILS

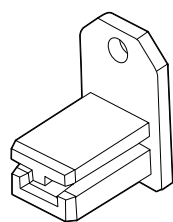

END CAP (RAIL III) WITH RING

Suits poster rail III, for a neat closing and suspension by the integrated ring, grey.

25735-03

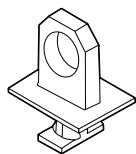

RAIL RING

To be directly turned into poster rails II and III for both - suspending the rail itself as well as the frames, grey.

25730-03



SUSPENSION RING

To suspend poster rails II and III, to be turned into top groove, clear.

25700-00

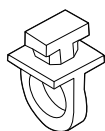

HANGING RING

To be turned into rails II and III to suspend frames, clear.

25710-00



CABLE SUSPENSION

Suitable to suspend our alu rails II, III, alu clamp rail 40 and priceboards. Adjustable wire cable Ø 1,2 mm with hooks, plate for a quick and easy, sideways insert into the rail profile. Further lengths are available upon request.

1000 mm		25696-00/1000
2000 mm		25696-00/2000
3000 mm		25696-00/3000



SUSPENSION SYSTEMS

ACCESSORIES FOR POSTER RAILS

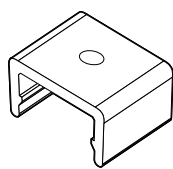

CEILING FASTENER
To fix poster rails II, III or profile frames series 500 directly to ceilings, clear.

25181-00

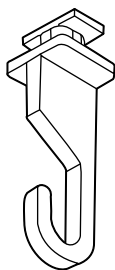
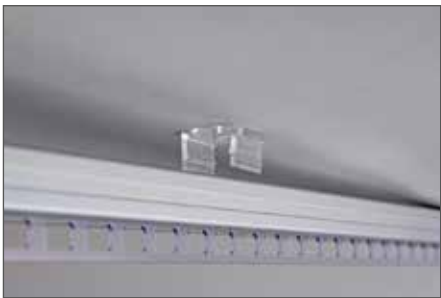

SUSPENSION HOOK
Suits poster rails II and III, to be turned directly into the rail profile, for suspension of frames and displays, clear.

25750-00

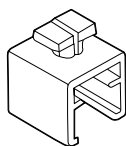

FRAME CLIP
Suits poster rails II and III, to be turned directly into the rail profile to suspend frames A6 - A3 (series 100) with lateral poster insert, clear.

25740-00

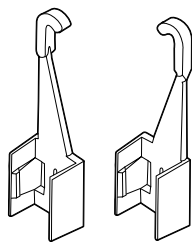

HANGING HOOK L = 54 MM (PAIR)
Suits poster rails II and III, to be hung directly into the rail profile to suspend frames A6 - A3 (series 100) with top poster insert, clear. Not suitable for Laminate- or DEKO-frames.

25760-00

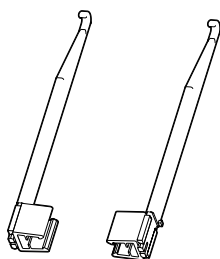

HANGING HOOK LONG L = 137 MM (PAIR)
Especially long hooks to suspend frames with top signs or headers with up to 10 cm, to be hung directly into poster rails II and III, clear.

25770-00



SUSPENSION SYSTEMS

POSTER RAIL ROUND TUBE

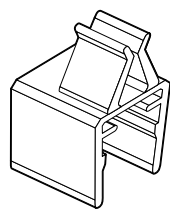

PROMOTION CARD CLIP

To fix promotion signs to poster rails II and III in a standing or hanging position, insert thickness 0,3 - 2,0 mm, clear.

25920-00

POSTER RAIL ROUND TUBE

Aluminium anodized tube Ø 20 mm, standard length 200 cm.

aluminium anodized		57810-91/xxxx
white (on request)		57810-01/xxxx
black (on request)		57810-10/xxxx



METAL TUBE CONNECTOR

For a stable connection of round tubes Ø 20 mm, aluminium.

25175-00

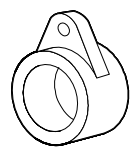

SUSPENSION RING

To suspend poster rail round tube, grey.

25160-03

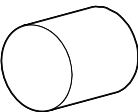

END CAP

Suits poster rail round tube, for a neat closing, grey.

25170-03

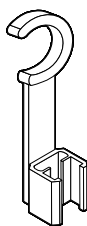
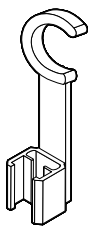
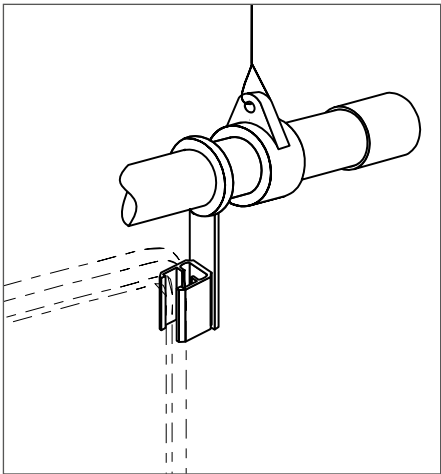

TUBE CLIP, SWIVEL TYPE (PAIR)

To suspend frames from round rails, tubes, etc., clip Ø 22 mm, clear.

series 100		21610-00
series 200		22610-00
series 500		25521-00



SUSPENSION SYSTEMS

SYSTEM TUBE QP WITH ACCESSORIES

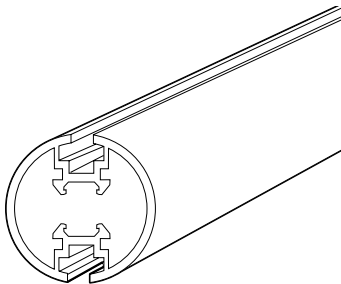

SYSTEM TUBE QUICKPRICE QP

Anodized aluminium, tube Ø 25 mm, length 200 cm. Special colors are available upon request.

15410-90/2000

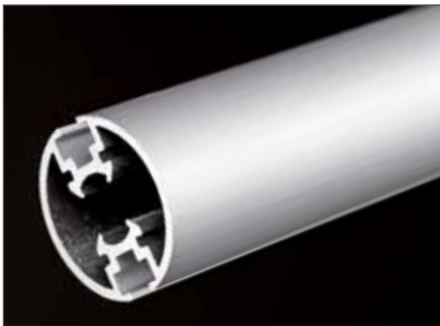

GRIP STRIP FOR SYSTEM TUBE QP

For a quick and easy suspension and change of frames, poster pockets, etc., made of clear plastics, length 200 cm.

22560-00/2000



END CAP QP

Suits system tube qP for a neat closing, grey.

25685-03

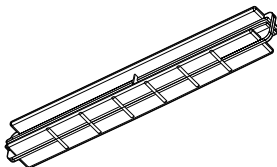

TUBE CONNECTOR QP

For a quick connection of single system tubes qP, length 160 mm, made of premium plastics, grey.

25603-03

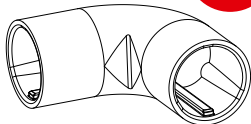
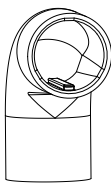

CORNER CONNECTOR QP 90°

To connect single system tubes qP around the corner, grey.

vertical

horizontal

25602-03

25602-03/W



SUSPENSION SYSTEMS

SYSTEM TUBE QP WITH ACCESSORIES

TUBE CONNECTOR QP WITH RING
To connect single system tubes qP, length 60 mm, made of zinc coated metal with 2 fixing screws and integrated ring.

25606-00



CABLE SUSPENSION FOR QP SYSTEM TUBE
Suitable to suspend our system tube qP. Adjustable wire cable Ø 1,2 mm with hooks, plate for a quick and easy, sideways insert into the rail profile. Further lengths are available upon request.

1000 mm		25697-00/1000
2000 mm		25697-00/2000
3000 mm		25697-00/3000



SUSPENSION HOOK QP
To suspend frames, poster pockets, etc., to be turned sideways into qP tube profile, clear.

25751-00



SUSPENSION RING QP
To suspend frames, poster pockets, etc. using C- or S-hooks, to be turned into qP tube profile from sideways, clear.

21362-00

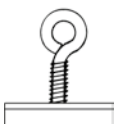

SUSPENSION RING (ALU) FOR SYSTEM TUBE QP
Stable suspension ring Ø 5 mm made of aluminium T-profile, to be inserted into the qP tube profile for a secure fixing.

21363-00

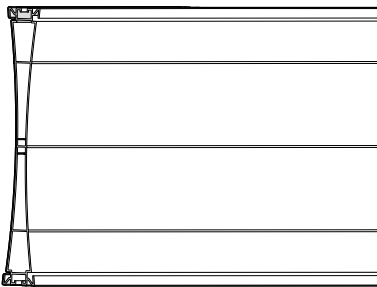

PRICEBOARD

Extruded, concave shaped profile made of premium plastics, for double-sided insert of posters A5 or A4. Colors and lengths are available upon request.

A5		15420-xx/xxxx
A4		15421-xx/xxxx

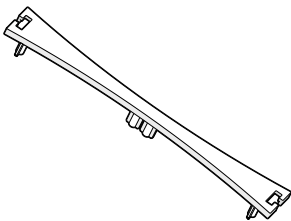

END CAP FOR PRICEBOARD

For a neat closing. Colors upon request.

A5		25690-xx
A4		25691-xx

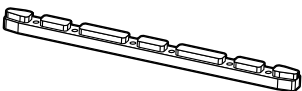

CONNECTOR FOR PRICEBOARD

To connect single priceboards, we recommend to use 2 connectors (top and bottom), made of plastics with screws. Colors upon request.

25692-xx

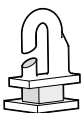

SUSPENSION RING FOR PRICEBOARD

To be turned into the priceboard profile, for suspension to be used together with C-hooks or knot chain. Also suitable to mount aluminium poster rail II and III. Colors upon request.

25694-xx



SUSPENSION SYSTEMS

CLAMP- AND SNAP RAILS

CLAMP- AND SNAP RAILS

Would you like to hang up big-size posters? No problem when using OEK rails. The clamp and snap mechanism of the different rails as well as various types of profiles and materials provide quick and easy handling along with an elegant design.

Remark:
You will find the suitable fixing elements on the following pages under the heading → **mounting accessories**.
For the alu clamp rail 40 all the → **accessories profile frames (series 500)** can be used.



POSTER CLAMP RAIL 15
Clear plastics, profile 15 mm, to insert papers from sideways, upper rail with 2 punched rings for suspension, 2-parts set. Standard lengths 500, 600, 790 and 1200 mm. PU: 10 sets.

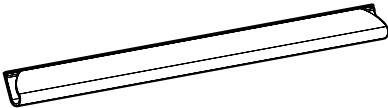

length 500 mm		15440-00/500
length 600 mm		15440-00/600
length 790 mm		15440-00/790
length 1200 mm		15440-00/1200

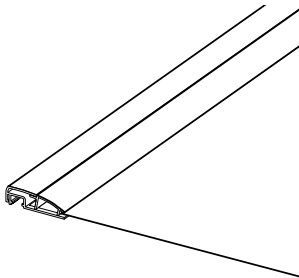

POSTER CLAMP RAIL 18
White plastics, profile 18 mm with snap mechanism, for papers up to 1 mm thickness, upper rail with 2 suspension rings, no adhesive tape, 2-parts set. PU: 10 sets.

Also available in further colors or with rear adhesive tape upon request.

special lengths		15452-01/xxxx
length 600 mm		15452-01/0600
length 980 mm		15452-01/0980

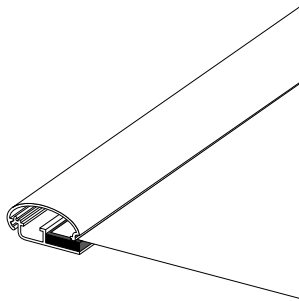

ALU SNAP RAIL 25
Anodized aluminium profile 25 mm with snap mechanism to clamp posters with material up to 3 mm thickness. Integrated rubber inlay ensures a secure clamp. Upper rail with 2 suspension rings, both rails with grey end caps, 2-parts set. Standard lengths.

length 600 mm | 71-50000-91/0600
length 850 mm | 71-50000-91/0850
length 1000 mm | 71-50000-91/1000



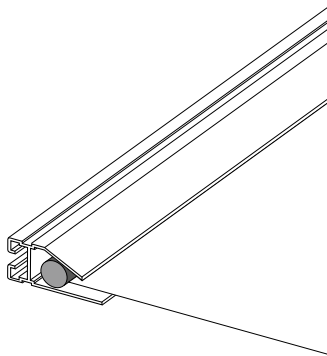

ALU-CLAMP RAIL 40 WITHOUT ADHESIVE
Anodized aluminium, profile 40 mm, to clamp papers, cartons, foils, etc. with up to 3 mm thickness. Standard lengths 500 and 1000 mm. Special lengths up to 2500 mm are available as from 10 sets min. upon request.

length 500 mm		50100-91/0500
length 1000 mm		50100-91/1000

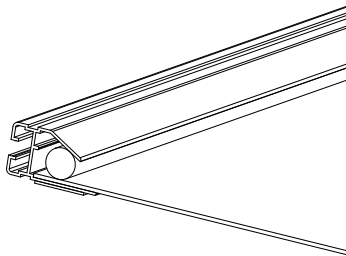

ALU-CLAMP RAIL 40 WITH ADHESIVE
Anodized aluminium, profile 40 mm, to clamp papers, cartons, foils, etc. with up to 3 mm thickness. With double foam adhesive tape. Standard lengths 500 and 1000 mm. Special lengths up to 2500 mm are available as from 10 sets min. upon request.

length 500 mm		50110-91/0500
length 1000 mm		50110-91/1000



MOUNTING ACCESSORIES

For mounting and suspending priceboards, aluminium poster rails, clamp- and snap rails etc. we offer a large and well-assorted selection of different accessories. If you have any specific demands on the fixing system, we will be happy to find an individual solution for you. Just contact us!

METAL CEILING CLIP
Clip for special Odenwald ceiling grid, to suspend poster rails, priceboards, etc., force up to 18 kgs, coated metal white. PU: 100 pcs.

20660-01



CADDY CLIP
Clip for special Odenwald ceiling grid, to suspend poster rails, priceboards, etc., force up to 18 kgs, zinc metal. PU: 100 pcs.

20679-00

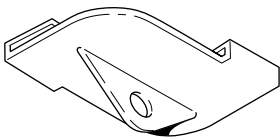

PLASTIC CEILING CLIP
Clip for special Odenwald ceiling grid, to suspend poster rails, priceboards, etc., force up to 4 kgs, plastics white. PU: 100 pcs.

20665-01



SUSPENSION SYSTEMS

MOUNTING ACCESSORIES

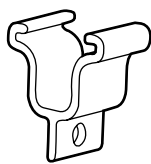

CEILING CLAMP

Clamp with ring Ø 4 mm for special Odenwald ceiling grid, to suspend poster rails, frames or displays with universal hooks, chains, cable suspensions etc., white, force up to approx. 3 kgs. PU: 100 pcs.

20678-01

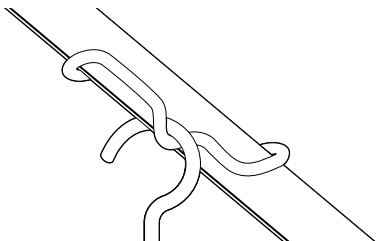

WIRE CEILING CLIP 20

Clip for special Odenwald ceiling grid, to suspend poster rails, frames, poster pockets or similar with hooks and chains. PU: 100 pcs.

20674-00



CEILING RING Ø 40 MM

With double foam adhesive tape, white.

20671-01

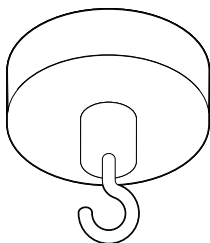

MAGNET FOR CEILING

To suspend poster rails, poster pockets or similar with hooks, chains, etc., magnetic force up to approx. 20 kgs (Ø 50 mm) resp. 8 kgs (Ø 32 mm), white.

Ø 32 mm		20637-01
Ø 50 mm		20635-01



UNIVERSAL HOOK

To hang poster rails, priceboards, poster pockets, etc. with knot chains, available in standard lengths 100, 150, 200, 250, 300, 400, 500 and 750 mm. PU: 50 pcs.

length 100 mm		24214-00/0100
length 150 mm		24214-00/0150
length 200 mm		24214-00/0200
length 250 mm		24214-00/0250
length 300 mm		24214-00/0300
length 400 mm		24214-00/0400
length 500 mm		24214-00/0500
length 750 mm		24214-00/0750



S-HOOK, 22 MM

To suspend poster rails, poster pockets, etc., with knot- or decochains, length 22 mm. PU: 100 pcs.

20685-00



C-HOOK

To suspend poster rails, poster pockets, etc. with knot- or decochains, PU: 100 pcs.

39 mm

20683-00

60 mm

20684-00



PLASTIC SUSPENSION HOOK FOR TUBES Ø 44 MM

Solid hook made of molded plastic to be riveted to alu snap rail or directly on to PVC pockets or covers. Suitable for up to 44 mm tube diameter. Easy hanging and change of posters, even from big heights using a telescopic rod (available upon request). Color: similar to RAL 9007 (grey aluminium).

84-15508-9007



METAL HOOKS FOR TUBES

Suitable for tubes Ø 35 mm, to suspend frames, poster pockets, etc., made of zinc coated metal. PU: 50 pcs.

25752-00



KNOT CHAIN K16

To hang poster rails, poster pockets or similar. PU: roll with 30 m.

20690-00



SUSPENSION SYSTEMS

MARKING FOR BEVERAGES



PRICE CASSETTE FOR BEVERAGES
QP 2236
Price cassette with plastic housing colored and 3 single cassette boxes to be opened individually, clear.
Top cassette for posters or wording A5 landscape. Lower cassette with folded number strips red/black and basic price information.
Size: 221 x 361 mm.
Colors white and red.
(Other colors available upon request).

14362-xx



DOUBLE CONNECTOR
To connect and suspend 2 single qP price cassettes or qP displays, clear.
PU: 20 pcs.
Available upon request.

24860-00



SUSPENSION Ø 12 MM
With hook for tubes Ø 12 mm, clear.
PU: 20 pcs.
Available upon request.

24800-00

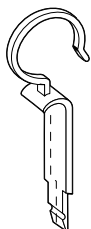

SUSPENSION HOOK Ø 26 MM
With hook for tubes Ø 26 mm, clear.
PU: 20 pcs.
Available upon request.

24810-00

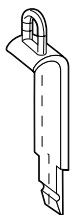

SUSPENSION RING

Suspension with ring, clear. PU: 20 pcs.
Available upon request.

24820-00



SUSPENSION

To suspend two single qP price cassettes
for beverages (back to back), clear.
PU: 20 pcs.
Available upon request.

24830-00

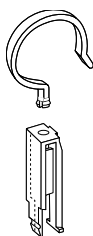

SUSPENSION (DOUBLE) WITH HOOK

To suspend two qP cassettes for beverages
(back to back), clear. PU: 20 pcs.
Available upon request.

24840-00



SINGLE PLASTIC CASSETTE FOR SPIRAL
BOUND NUMBER BLOCKS

Single plastic cassettes made of white
polystyrene to create customized price
displays. Based on PS slates, designed
and printed individually, requested cassette
combinations are fixed to the slate by US
welding, PVC pockets or covers can be
glued to the slate for additional promotional
information. Single- or double sided designs.

single cassette

40 x 80 mm

24630-01

76 x 80 mm

24620-01

76 x 181 mm

24610-01

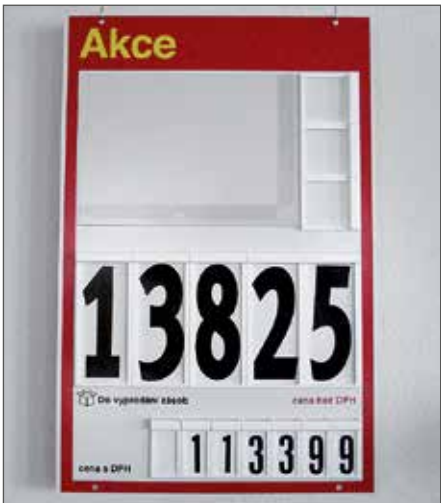

SUSPENSION SYSTEMS

MARKING FOR BEVERAGES



DIVERSE PRICE DISPLAYS FOR BEVERAGES

Price displays made of PS, different sizes and colors, upper section for insert of advertising posters A5 landscape, price marking (one-sided) with small spiral bound numbers or text inlays.

Available upon request.



POSTER BOARD 25 X 51 CM

Suitable for individual price marking with PC prints. To insert posters in upper part with size A5 landscape, lower section with poster pocket for inlays A4 portrait. Made of white PS, with red frame, single-sided.

PU: 10 pcs.

Available upon request

14541-06

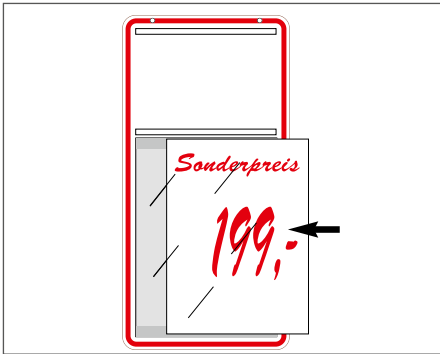

POSTER POCKET WITH CROSS BAR

To insert posters A5 landscape and A4 portrait, made of non-reflective PVC 0,4 mm, clear for fixing with special clamp hooks Ø 4 mm.

29607-A4A5/04



SUSPENSION COVER

For a quick and stable suspension of posters, with holes Ø 1 mm to be used with clamp hook Ø 4 mm, made of non-reflective, bent hard PVC 1 mm, clear.

A4 portrait		29800-A4/10
A4 landscape		29801-A4/10



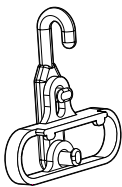

CLAMP HOOK Ø 4 MM

Fixed fitting, to be tightly clipped onto punched displays for beverages, suspension cover, etc. with up to 1 mm thickness, white. Suiting only for precise hole drillings of Ø 4 mm and a distance of 7 mm (distance between display edge and outer line of hole).

20680-26

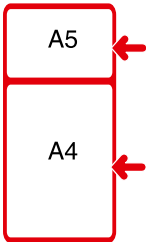

SHOWCARD FRAME WITH CROSS BAR - LSE

Showcard frame with cross bar for posters sizes A4 portrait and A5 landscape, long side poster entry, to be used with accessories (series 100). Colors: white, red, green.

11445-xx



CARDBOARD CLAMP 3

To attach onto cartons, boxes, boards etc. with material of up to max. 20 mm thickness. Top part for insert of promotion signs with up to 3 mm thickness, 2-parts, clear. Also functional for bigger carton signs. We recommend to use 2 clamps.

17040-00



CARDBOARD CLAMP WITH METAL SPRING

To attach onto crates, wooden boxes and other packings. Suitable for material thickness 0,5 up to max. 3 mm. Height 140 mm, width 60 mm. Width of spring: approx. 15 mm. Color: clear.

17090-00

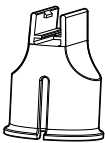

BOTTLE HOLDER SERIES 100

Fitting onto all PET bottles (1,5 L - 1,0 L - 0,5 L), holding showcard frames (series 100), clear.

20025-00

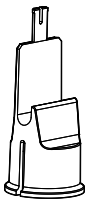

KLICK BOTTLE HOLDER

Fitting onto all PET bottles (1,5 L - 1,0 L - 0,5 L), with rear Klick adaptor to hold qp price cassettes, shelf barkers, etc., colors: clear, grey.

20026-00

